



BROCHURE |
www.cbcons.com.vn

The Introduction

We provide comprehensive services to client by offering services as following:

- FEASIBILITY STUDY / CONSTRUCTION PERMITS [1]
- DESIGN & ENGINEERING / BIM [2]
- CONSTRUCTION (CIVIL, INFRASTRUCTURE, M&E) [3]
- MAINTENANCE & MANAGEMENT OF PROJECT [4]

About us

CBC has formulized as Design & Build (D&B) Contractor in Industrial field of constructing all kinds of Factory, Warehouse, Showroom, Shipyard, Cold Storage, Feed Mill, Aviation Terminal,... Infrastructure & MEP work.

Adhering to innovative and engineering solutions through deep experience with more than 1000 projects designed & built, CBC shall complete your project not only maximum use & operation but also cost effectiveness.

Commitment

CBC shall contribute our human resource & intelligence to build the best projects and make the better future for everyone.

Core Value

- 1 People
- 2 Integrity
- 3 Innovation
- 4 Sharing

Business Orientation

- OBSERVE THE LAWS [1]
- MAINTAIN A CLEAN CULTURE [2]
- RESPECT COMMUNITIES, CLIENTS, EMPLOYEES, PARTNERS... [3]
- VALUE HEALTH & SAFETY [4]
- BE RESPONSIBLE FOR SOCIETY [5]

CBC Principle

SELECTIONS

1. Free Design Consultant.

Investment advice included geographic location, raw material areas, policies to attract local investors, industrial zones, transportation, labor, etc.

2.

Legal advice included construction permit, FP fire permit, records of environmental impact assessment in accordance with Vietnamese laws.

3.

Technical support, optimization of construction measures.

4.

5. Execution of works.

We understand that the investors are always looking for capable partners providing diversified choices as the design consultant solutions, full package construction. On the mission satisfy your need, our development orientation is to provide Customers D&B (Design & Build) services.

Customers would be carefully advised by top construction experts for the appropriate selections.

Scope of work

DESIGN & BUILD POLICY.

Basic Design

Free

Construction Drawing

Low cost

Design and Build



FREE Design Consultant

Infrastructure & Civil Work

This mega garment project had been constructed by CBC within 24 months & complied with LEED Gold standard, Environment & Eco-friendly Global project.

After completion, its operation will create the career for 20,000 Cambodians & support Cambodia economic growth.

* 22 buildings of 400,000 m2 construction comprising 16 factories, warehouses & utilities & 6 dormitories.

* And infrastructure works of 14km internal road & drainage system & traffic lighting.

Marvel Garment Project (phase 1 & 2)

Land Area
460.000 m²

Scope
Civil
MEP
Steel Structure
Infrastructure Work



Steel Structure Work

With 03 factories of 90,000 m² in the Southern & Northern of Vietnam, we are able to manufacture & supply 5000 MT/month ~ 100,000 m² steel building/month.

The latest American Standards as MBMA, AISC, ASTM, AWS... are applied for Design, Fabrication & Erection in one roof of CBC construction work.

3D Model by TEKLA software for Shop Design & 3D BIM Size for checking & doing erection at site, exactly we are assurance of quality management.



Steel factory in Vietnam



Steel factory in Cambodia

Sailun Cambodia Factory

Land Area
460.000 m²





Scope
Civil
MEP
Steel Structure
Infrastructure Work



MEP
Work

01
Electricity

BACKUP GENERATOR SYSTEM ■	DYNAMIC ELECTRICAL SYSTEM ■	ELV SYSTEM ■	INDOOR LIGHTING SYSTEM ■	OUTDOOR LIGHTING SYSTEM ■
				

FIRE SPRINKLER SYSTEM ■	FIRE ALARM SYSTEM ■	FIRE FIGHTING PUMPER ■	FIRE FIGHTING SYSTEM ■	ELECTRIC PANEL FIRE CONTROL SYSTEM ■
				

02
Fire Alarm &
Fire Fighting

03

Plumbing Sanitary (P&S)



■ WATER TANK



■ WATER-PIPE SYSTEM



■ WATER PUMPING SYSTEM



■ WATER SUPPLY SYSTEM



■ WASTEWATER TREATMENT SYSTEM



■ SANITARY

04

Heating Ventilation Air Conditioning (HVAC)



■ EVAPORATIVE COOLING PAD



■ COOLING PAD SYSTEM



■ PIPE VENTILATION



■ ROOF TURBINE VENTILATOR



■ EXHAUST FAN SYSTEM



■ AIR CONDITIONER SYSTEM

Quality Assurance Management.

Quality Control

CBC has held **ISO 9001:2015 & ISO 45001:2018** quality management system certification since 2008 and used it to operate smoothly all processes of quality control and quality assurance.

With its operation, CBC is approaching zero-defect quality goal by continuous improvement, preventive operation, strict quality control as well as a worksite support system through our experts group.

Process Management with PDCA

PLAN

Plan in optimum process of design and execution at the beginning of every project.

DO

Do all detail works in the plan correctly and exactly.

CHECK

Check to analyze the project result of quality, schedule and safety strictly.

ACT

Act to improve / innovate the process to make it even better day after day.

Maximize Added Value for Client.



BIM (Building Information Modeling) Software for Project Management.

Besides through VR application, CBC would let the clients to be able to see , imagine & touch his future project in reality with 3D & 4D modeling before making any decision forward.

With our talent team, CBC has used BIM in project management of DESIGN, QUANTITY, SCHEDULE & MAINTENANCE in order to make:

- OPTIMUM DESIGN [1]
- SAVING COST [2]
- MANAGING TIME [3]
- EASY MAINTENANCE [4]



Safety Management

Work safety is a vital prerequisite to ensure the life of workers, beliefs and brand reputation of CBC Construction.

In order to ensure safety, the Board of Labor Safety has continuously made strong improvement to create the best working environment for employees, while improving productivity and labor efficiency. Every year, the labor safety force is always invested not only the quantity but also the quality, continuously focus on internal training as well as the training of safety experts domestically and internationally to improve the skills of guidance, control, identification and comprehensive risk evaluation to provide the best safety solutions for workers.

At CBC, the Labor Safety Management System was built from the beginning and has been increasingly improved.



ISO 45001:2018 Quality Management System



ISO 9001:2015 Occupation Health & Safety Management System

Environment Management



CBC always recommends clients to apply LEED standards in their design & building project. We would deliver Green Building Design, Environment Friendly Construction & Energy Cost Saving in operation for our clients.

By application of LEED standards, CBC would help the clients to Decrease operation cost, Increase asset value, Ensure productivity & Make comfort & health not only for occupants but also for employees.

CBC has determined a responsibility to minimize all environmental impacts associated with our construction activities and has applied the ISO 1400 -International Environmental Management Standard.

We will continue to carry out eco-friendly management activities based on the environment management system.

Social Responsibility



At CBC, we clearly determine the responsibility with social. Our mission is "Together we make the better future" for CBCers & Disadvantage Children in Vietnam, South Asia & where CBC is.

It is engaged in various CSR activities as following:

BUILDING LOVE SCHOOL & LOVE LIBRARY [1]



TUTORING DISADVANTAGE CHILDREN A BASIC EDUCATION PROGRAM [2]



TRAINING NEW KNOWLEDGE & TECHNOLOGY OF DESIGN & CONSTRUCTION [3]



LOVE SHARE FUND WITH DONATION TRIPS TO RURAL AREAS & HELPING PEOPLE THERE [4]



OUR MISSION IS

*Together We Build
The Better Future*



TYPICAL PROJECTS



Investor: **C.P. Group**
Bldg Area: **200.000 m²**
Location: **Khanh An IP, U Minh, Ca Mau**





Investor: **Worldon (Vietnam) Co., Ltd** 

Bldg Area: **220.000 m²**

Location: **Dong Nam IP, Cu Chi**



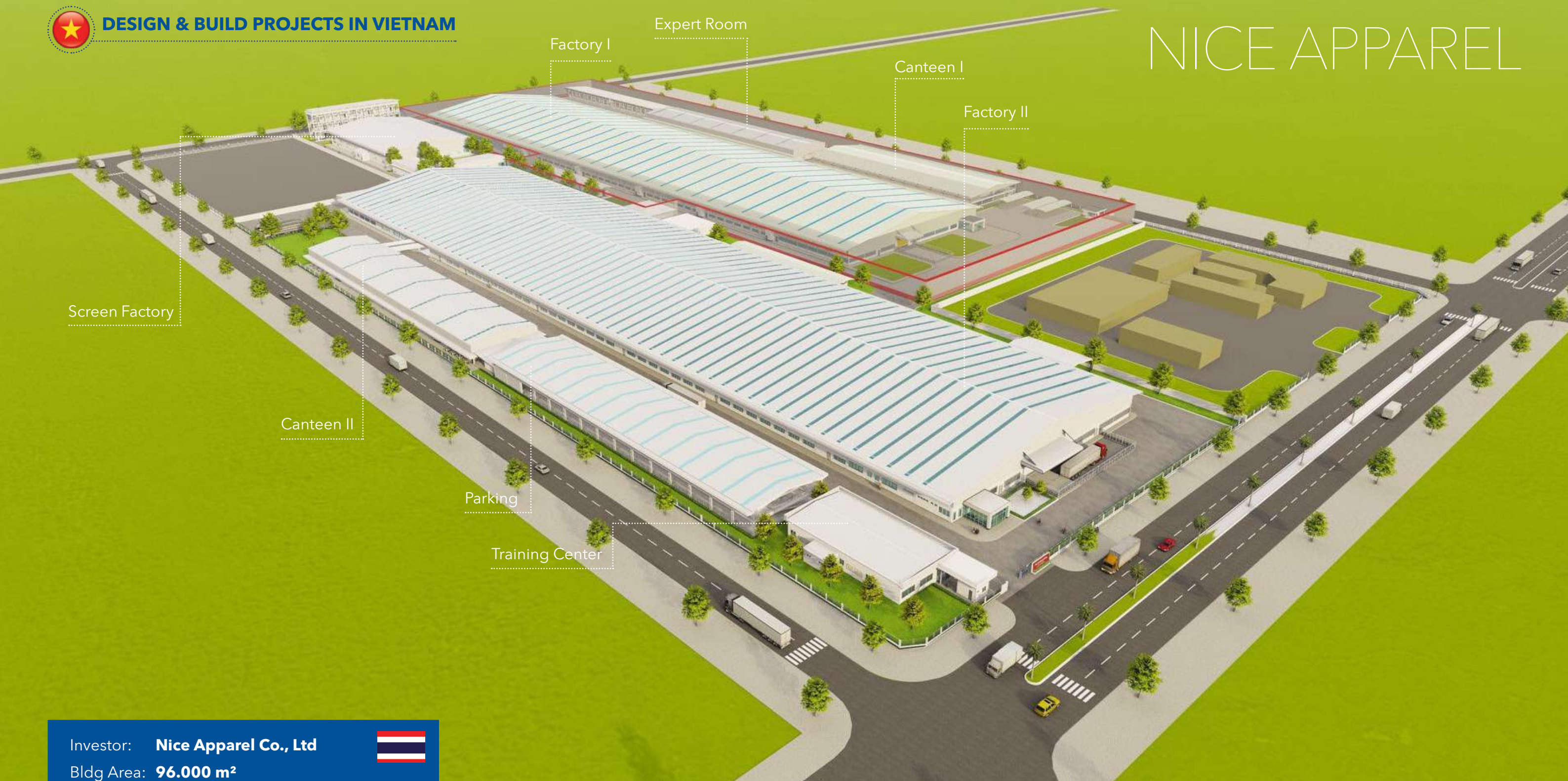

Investor: **Nice Apparel Co., Ltd**



Bldg Area: **96.000 m²**

Location: **Binh Hoa IP, Chau Thanh, An Giang**





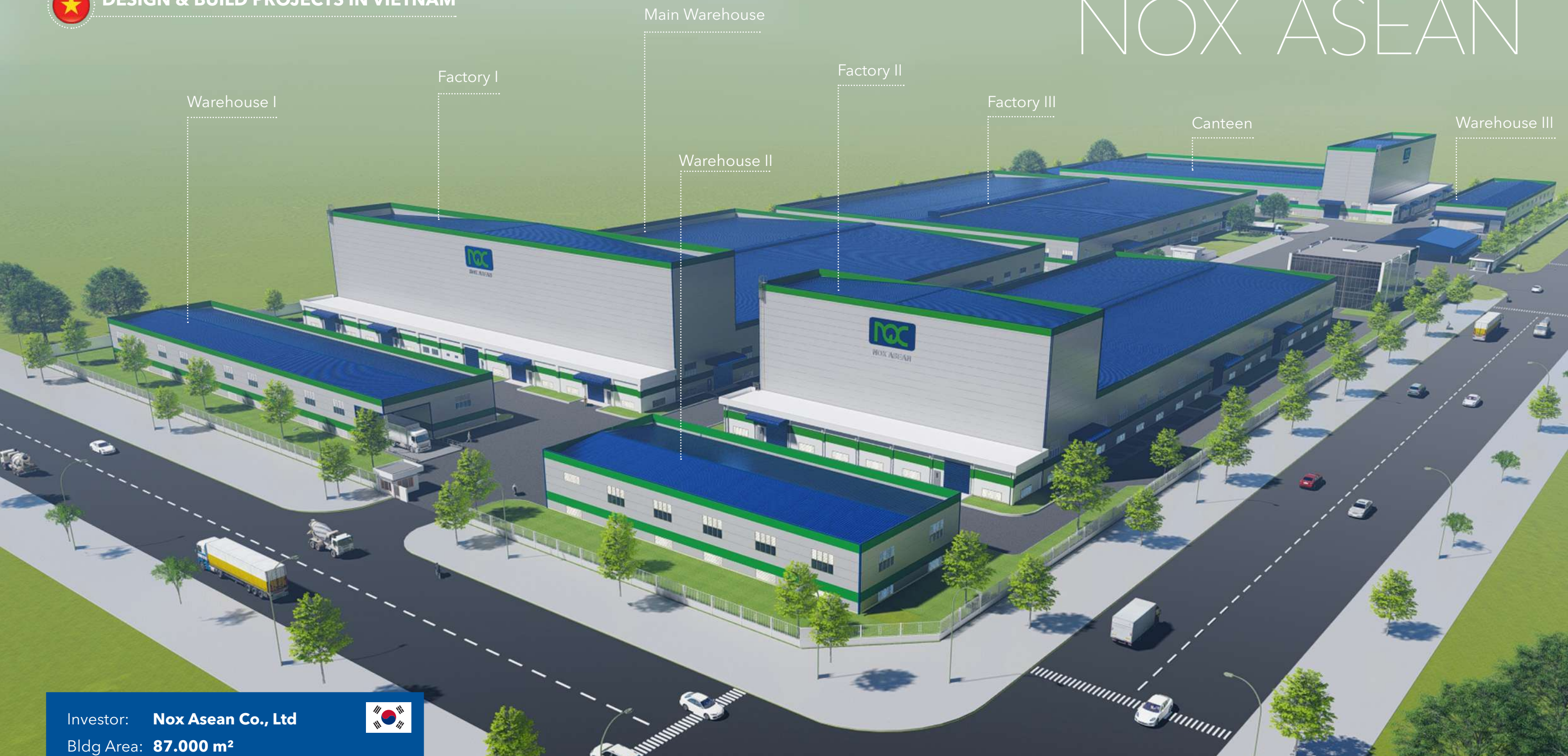

NOX ASEAN



Investor: **Nox Asean Co., Ltd**
Bldg Area: **87.000 m²**
Location: **Nhon Trach VI IP, Dong Nai**

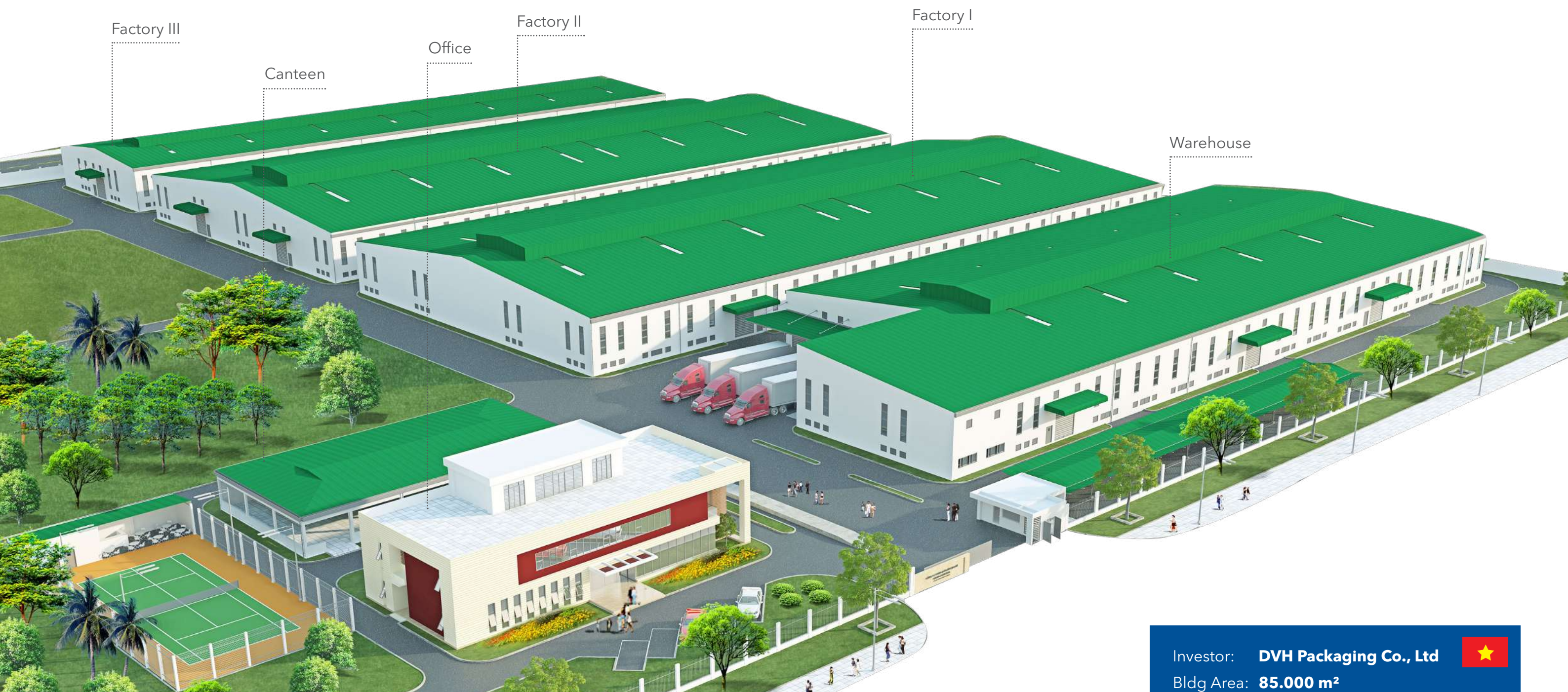



Investor: **DVH Packaging Co., Ltd** 
 Bldg Area: **85.000 m²**
 Location: **Hai Son IP, Duc Hoa, Long An**





Investor: **Rang Dong Healthcare JSC**



Bldg Area: **82.820 m²**

Location: **Tan Do IP, Long An**





Investor: **Kingwood International Enterprises Ltd.** 

Bldg Area: **55.000 m²**

Location: **Tan Binh IP, Binh Duong**





A.J.PLAST VIETNAM FACTORY - PHASE 1



Investor: **A.J.PLAST Co., Ltd**

Bldg Area: **70.673 m²**

Location: **Bau Bang Expansion IP, Binh Duong**





ENTOBEL ANIMAL FEED INGREDIENT



Investor: **Entobel Ba Ria - Vung Tau Co., Ltd**



Bldg Area: **45.636 m²**

Location: **Dat Do I IP, Ba Ria - Vung Tau**





VIETNAM TRIM PARK

Investor: **Shimada Shoji Co., Ltd**



Bldg Area: **35.705 m²**

Location: **Protrade International Tech Park, Binh Duong**





IMG PHUOC DONG

Investor: **IMG Phuoc Dong JSC**



Bldg Area: **38.400 m²**

Location: **Phuoc Dong Industrial Park & Port, Long An**





PANEL PLUS VIETNAM FACTORY



Investor: **Panel Plus Vietnam Co., Ltd**



Bldg Area: **22.000 m²**

Location: **Giang Dien, Dong Nai**





SADESA VIETNAM LLC FACTORY



Investor: **Sadesa Vietnam LLC**
Bldg Area: **22.976m²**
Location: **Phu My 3 SIP, Ba Ria - Vung Tau**



DUY TAN LONG AN FACTORY



Investor: **Duy Tan Plastics Corp** 
 Bldg Area: **180.000 m2**
 Location: **Tan Do IP, Duc Hoa, Long An**



BATILOGISTIC HO CHI MINH PHASE 2



Investor: **Bati Ho Chi Minh LLC** 
Bldg Area: **16.000 m²**
Location: **VSIP II Industrial Park, Binh Duong**



HAOHUA VIETNAM LLC FACTORY



Investor: **Haohua (Vietnam) Co.,Ltd** 
Bldg Area: **430.000 m²**
Location: **Minh Hung - Sikico Industrial Park, Binh Phuoc**



CARGILL PROVIMI DONG NAI

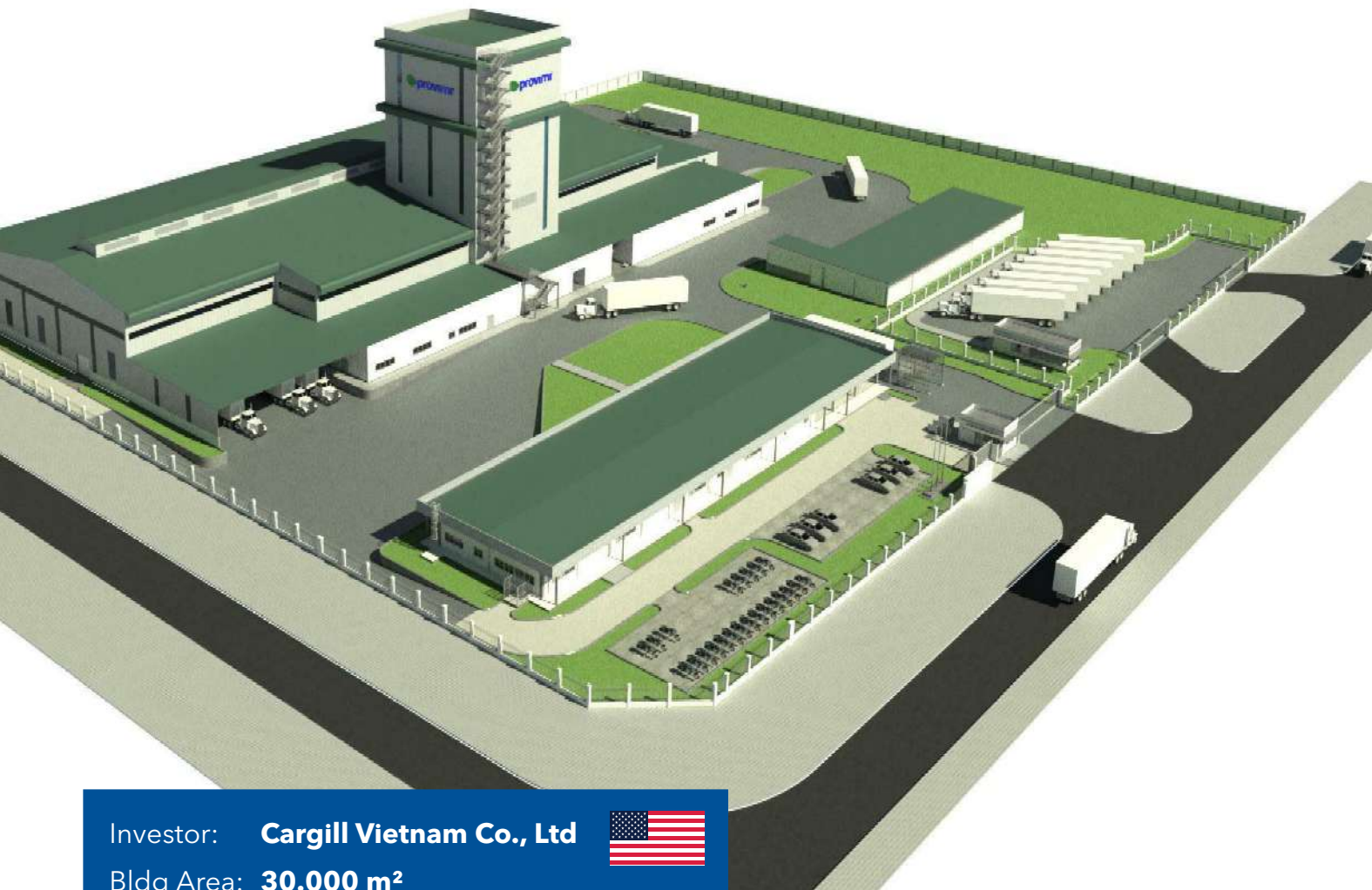

Investor: **Cargill Vietnam Co., Ltd** 
Bldg Area: **30.000 m²**
Location: **Giang Dien IP, Dong Nai**

HAI TRI



Investor: **Hai Tri Corp** 
Bldg Area: **30.000 m²**
Location: **An Nghiep IP, Soc Trang**





COFO TIRE



Investor: **COFO Vietnam Co., Ltd**
Bldg Area: **330.000 m²**
Location: **Bim Son, Thanh Hoa**



HANH MINH THI



Investor: **Hanh Minh Thi - Long An JSC**
 Bldg Area: **15.000 m²**
 Location: **Long Hau IP, Long An**



JINYU TBR TIRE



Investor: **Jinyu (Vietnam) Tire Co., Ltd**
 Bldg Area: **28.000 m²**
 Location: **Phuoc Dong IP, Tay Ninh**



TAN HOANG GIA FURNITURE



Investor: **Tan Hoang Gia Co., Ltd** 
 Bldg Area: **90.000 m²**
 Location: **Dong Nam IP, Cu Chi, HCMC**

SHOWROOM HONDA



Investor: **Phuoc Vien Co., Ltd** 
 Bldg Area: **6.000 m²**
 Location: **Binh Chanh, HCMC**



BITI'S FACTORY



Investor: **Binh Tien Co., Ltd** 
 Bldg Area: **15.000 m²**
 Location: **Tan An, Long An**



FRESCOL TUNA FACTORY



Investor: **Frescol Tuna (Vietnam) Co.,Ltd** 
 Bldg Area: **11.000 m²**
 Location: **Nam Cam IP, Nghi Loc, Nghe An**





THANH CONG VIET HUNG AUTOMOBILE FACTORY



Investor: **Thanh Cong Group**

Bldg Area: **360.000 m²**

Location: **Ha Long, Quang Ninh**





NVC LIGHTING



Investor: **NVC Technology and Lighting Co., Ltd** 
Bldg Area: **30.000 m²**
Location: **Yen Phong Extention IP, Bac Ninh**





I.P.ONE (VIETNAM) FACTORY



Investor: **I.P. One (Vietnam) Company Limited**



Bldg Area: **59.158 m²**

Location: **Becamex Binh Phuoc IP, Binh Phuoc**





CNC FEEDMILL

Investor: **CNC International Nutrition JSC** 
Bldg Area: **27.000 m²**
Location: **Ba Hang Industrial Clusters, Hai Duong**



SASI



Investor: **Saigon Auto Supporting Industry JSC** 
 Bldg Area: **22.000m²**
 Location: **HCMC's Automotive - Mechanical IP, Cu Chi**



ANGLO ASIA PROJECT



Investor: **Siam Services and Consultancy Co., Ltd** 
 Bldg Area: **52.300 m²**
 Location: **Thailand**





PHNOM PENH SEZ PLC. MARVEL GARMENT FACTORY



Investor: **Marvel Garment Co., Ltd**



Bldg Area: **600.000 m²**

Location: **PPSEZ, Phnom Penh**





KERRY WORLD BRIDGE LOGISTICS



Investor: **Kerry International Corporation**
Land Area: **120.000 m²**
Location: **National Road #2, Khan Dangkor, Phnom Penh**





SAILUN CAMBODIA



Investor: **Cart Tire Co., Ltd** 
Land Area: **88.000 m²**
Location: **Qilu Industrial Zone**





CAUSHKA CO., LTD CONSTRUCTION PROJECT AREA C



Investor: **Caushka Co., Ltd**

Land Area: **100.000 m²**

Location: **Qilu SEZ, Svay Reing, Cambodia**





LAURELTON DIAMONDS EXTENTION FACTORY

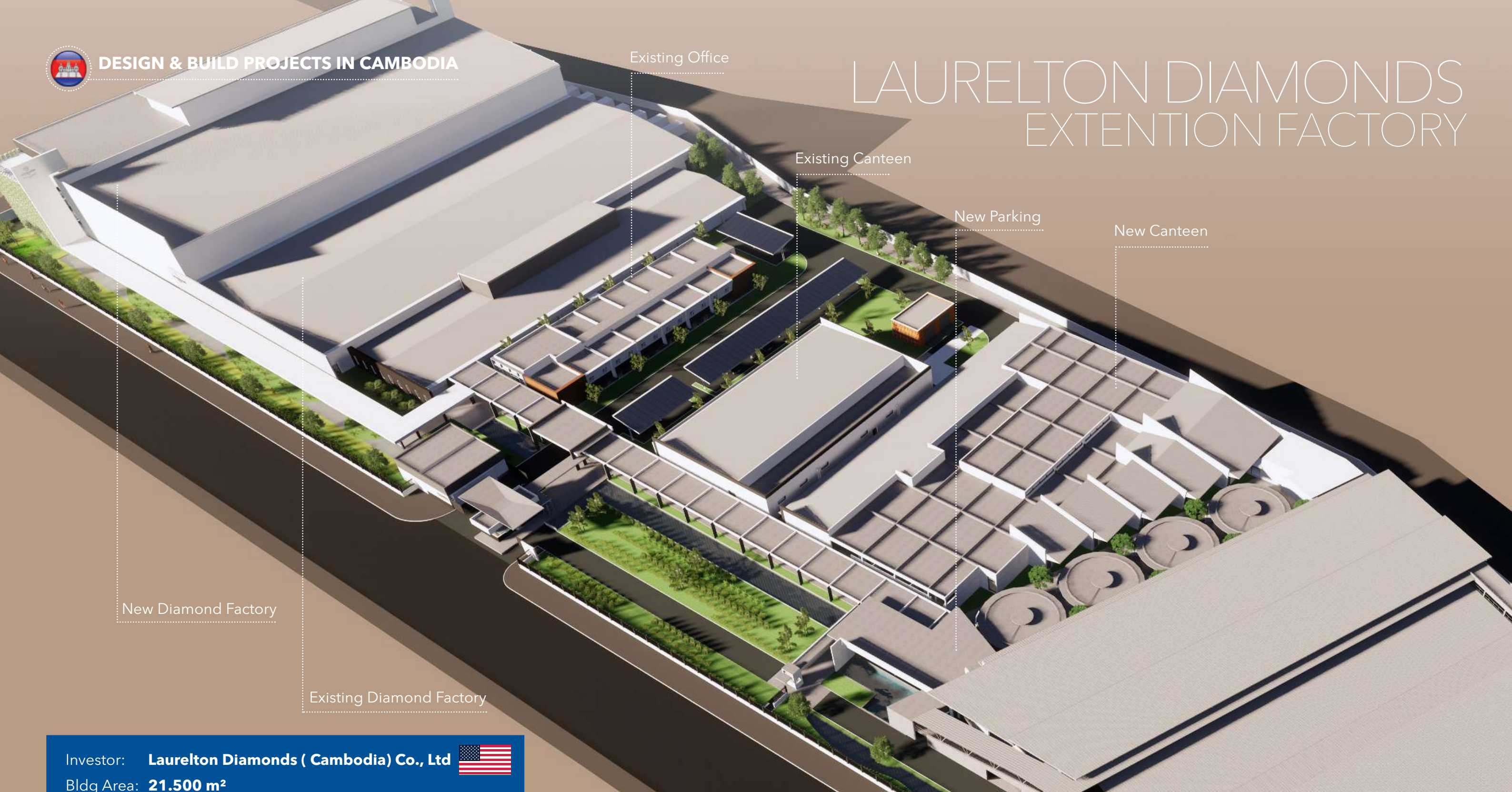

Investor: **Laurelton Diamonds (Cambodia) Co., Ltd** 
Bldg Area: **21.500 m²**
Location: **PPSEZ, Phnom Penh**





OJI PACKAGING FACTORY



Investor: **Oji Packaging Co., Ltd**
Bldg Area: **28.000 m²**
Location: **PPSEZ , Phnom Penh**





BIDC BANK



Investor: **BIDC Bank**
Bldg Area: **3.000 m²**
Location: **Phnom Penh**





AEON MALL DC



Investor: **Aeon Cambodia**
Bldg Area: **40.000 m²**
Location: **Sihanouk Ville, Cambodia**



Investor: **Pou Chen Group**
Bldg Area: **100.000 m²**
Location: **Kampot, Cambodia**





CARABAO DANG FACTORY



Investor: **Carabao Cambodia Co., LTD.**



Bldg Area: **40.000 m²**

Location: **Phnom Penh, Cambodia**

CHANGBEER CAMBODIA PROJECT



Investor: **Chang Beer Cambodia Co., Ltd**



Area: **10.000m²**

Location: **Kandal, Cambodia**





SHOWROOM TOYOTA



Investor: **Toyota Cambodia**
Bldg Area: **10.000 m²**
Location: **Phnom Penh, Cambodia**



AEON MALL PHNOM PENH



Investor: **Aeon Cambodia**
Bldg Area: **10.000 m²**
Location: **Phnom Penh, Cambodia**





URC MYANMAR



Investor: **URC Group Philippines**



Bldg Area: **48.000 m²**

Location: **Mingaladon**





GREEN FIELD PETFOOD PROJECT



Investor: **Perfect Companion Co.,Ltd.**



Bldg Area: **45.000 m²**

Location: **Bago Industrial Zone**

EURO PAC WAREHOUSE



Investor: **Myanmar Euro Pac Forwarding Co., Ltd**



Bldg Area: **12.000 m²**

Location: **Dagon Seiken, Yangon**



Together We Build
The Better Future

E-Brochure



Version

Revision No.: 09

Revision Date: 07-2025

Together We Build The Better Future

VIETNAM OFFICE

Head Office

A: 176A Tran Ke Xuong, Cau Kieu Ward,
HCMC, Vietnam

P: (+84) 28 3517 3187/89

Hanoi Office

A: 57 Lang Ha, O Cho Dua Ward,
Hanoi City, Vietnam

P: (+84) 24 3205 1266

OVERSEA OFFICE

Cambodia Office

A: No. 714, National Road No. 1, Phum
Boeng Chhuk, Sangkat Nirouth, Khan
Chbar Ampov, Phnom Penh, Cambodia

P: (+855) 23 213 442

Myanmar Office

A: 34/A Ani Gar Street (15) Quarter,
Yankin Township, Yangon, Myanmar

P: (+84) 913 763 132

